



*Gardens  
at Wynslow Park*

North Raleigh's Newest Classic • 919.876.3635

*Classic by definition... comfortable by design... Gardens at Wynslow Park are North Raleigh's newest classic. Stately archways and impressive 100% red brick exteriors create a lasting impression of quality. Residents enjoy numerous prevailing amenities such as prewiring for high-speed internet access, home entertainment systems, and computer networking. Come home to the Gardens at Wynslow Park today and discover these tastefully designed apartment homes built for today with tomorrow in mind.*





One Bedroom: 810 Sq. Feet

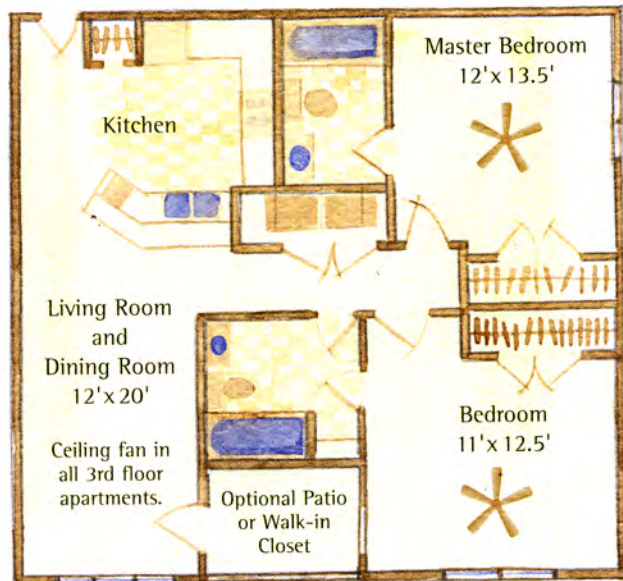

Two Bedrooms: 1,075 Sq. Feet

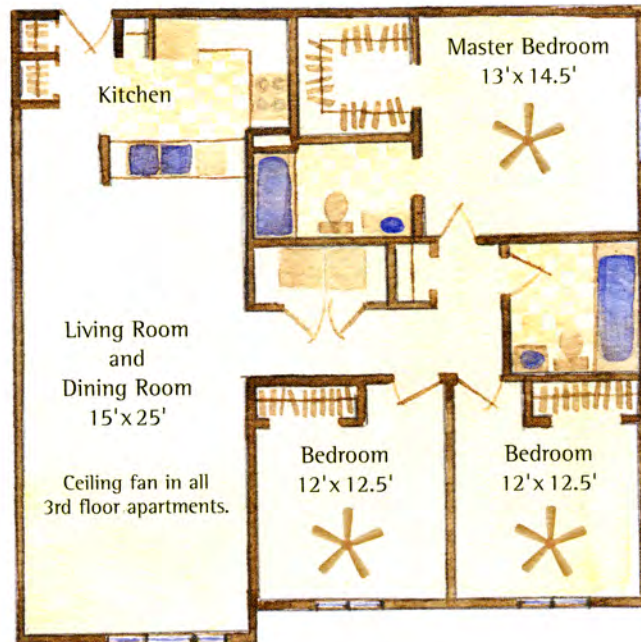

Three Bedrooms: 1,432 Sq. Feet

## *Apartment Features*

One-, two- and three-bedroom apartment homes, ranging from 810 - 1,432 square feet

- Built-in microwaves
- Connections for full-size washer and dryer
- Lighted ceiling fans
- Huge walk-in closets
- Spacious linen closets and pantries
- White Whirlpool appliances
- Patios and balconies
- Nine-foot ceilings in select units
- Energy efficient construction (heat pumps)
- Fire sprinkler systems
- Oversized windows
- Intrusion alarms

# Gardens at Wynslow Park Community

These brand new apartment homes feature elegant architectural styling with 100% red brick exteriors and massive windows that allow the sun to accentuate your living space. Gardens at Wynslow Park...where tradition and style meet awe-inspiring splendor. Enjoy resort-style amenities in a traditionally graceful environment.

- 100% red brick exteriors
- Detached garages with remote openers
- 24-hour fitness center
- Executive business center
- Pristine swimming pool
- Poolside gas grill
- Playground
- Walking/Jogging trail with fitness stations
- 24-hour professional maintenance
- Family picnic and recreational areas
- Luscious landscaping throughout
- Complimentary DVD library
- Patios and balconies with storage rooms
- Car care center
- Pet exercise area
- Document shredding bins
- Monthly resident socials
- VISA/MasterCard accepted



Directions: From the RDU Airport, take I-540 North/East to Louisburg Road/401 South. Proceed south on Louisburg Road approximately 2 miles. Turn left onto Fox Road. Gardens at Wynslow clubhouse is on the left.

From 64 East, take the I-440 East exit. Take the US 1 North/Capital Boulevard exit toward Wake Forest/Louisburg. Bear right onto US 401 North (Louisburg Road). Gardens at Wynslow Park is approximately 1/2 mile past New Hope Church Road.

Gardens at Wynslow Park Apartments · 4211 Fox Road · Raleigh, NC 27616 [www.wynslowparkapartments.com](http://www.wynslowparkapartments.com)  
Phone 919.876.3635 · Fax 919.790.9228 · e-mail [lease@wynslowparkapartments.com](mailto:lease@wynslowparkapartments.com)

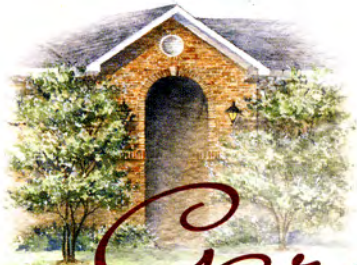

# *Gardens at Wynslow Park*

## *Proximity to Points of Interest:*

- I-540 – 2 miles
- Triangle Town Center – 2 miles
- Wake Medical Center – 4 miles
- I-440 – 2 miles
- RDU Airport – 9 miles
- Research Triangle Park – 11 miles
- State Capitol – 7 miles
- Wake Technical Community College – 0.5 miles

## *Achieve Your \$Dream\$...*

Kenney Realty Services offers residents of all Kenney Communities participation in the Triangle's premier home purchase program. Achieve Your \$Dream\$ allows residents to earn monthly Dream Points which are converted to cash when either a new or existing home is purchased. Live at a Kenney Community, and let us help you achieve your dreams!

*Kenney Realty Services*



EQUAL HOUSING  
OPPORTUNITY